

TOP FLANGE

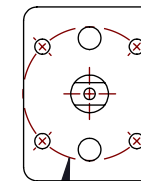

ISO 5211-F07

NOTES:

1. CERTIFIED TO MEET THE REQUIREMENTS OF: NSF/ANSI 61 AND NSF/ANSI 372, MSS SP-72.
2. CAST 316 STAINLESS STEEL (CF8M).
3. PRESSURE: 150 PSI WSP / 300 PSI WOG.
4. TEMPERATURE: 366°F.
5. WEIGHT: 16 LBS.



4940 Peachtree Industrial Blvd, #390
Berkeley Lake, GA 30071, USA
Ph: 800 645 0101

This file and any associated information and specifications are provided for reference and evaluation purposes only, and is subject to change without notice. AMERICAN VALVE makes no representations, warranties or guarantees as to the appropriateness, accuracy, completeness, or suitability for any purpose, of the file, information or specifications. You are solely responsible for the use of the file, information or specifications.

ION-4001-015

4001 1 1/2" CF8M Stainless Steel Flanged
Raised Face - Full Port Ball Valve 150#
with 2in. Square Operator Nut

SCALE	NTS
UNIT	INCH
SHEET	1 of 1