

TOP FLANGE

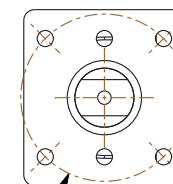

ISO 5211-F12

NOTES:

1. CERTIFIED TO MEET THE REQUIREMENTS OF: NSF/ANSI 61, NSF/ANSI 372, MSS SP-72, FED. SPEC. WW-V-35 AND AWWA C507-99 (PROOF OF DESIGN).
2. FACE TO FACE: ANSI B16.10.
3. A126 CLASS B CAST IRON BODY.
4. PRESSURE: 125 PSI WSP / 200 PSI WOG.
5. TEMPERATURE: 353°F.
6. WEIGHT: 149 LBS.



4940 Peachtree Industrial Blvd, #390
Berkeley Lake, GA 30071, USA
Ph: 800 645 0101

This file and any associated information and specifications are provided for reference and evaluation purposes only, and is subject to change without notice. AMERICAN VALVE makes no representations, warranties or guarantees as to the appropriateness, accuracy, completeness, or suitability for any purpose, of the file, information or specifications. You are solely responsible for the use of the file, information or specifications.

ION-4000-060

4000 6" Cast Iron Flanged
Full Port Ball Valve
125# with 2in. Square Operator Nut

SCALE	NTS
UNIT	INCH
SHEET	1 of 1